

Centralized Controllers

► Touch Screen Centralized Control

AUX touch screen centralized controller is a multifunctional device that can control up to 256 indoor units within a maximum connection length of 1200meters. Users could enjoy the flexibility of either controlling multiple units as a group or controlling each unit individually.

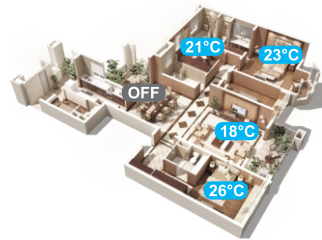

► Multi-system Control

256 indoor units with no repeated address from different outdoor systems could be centralized controlled together. this greatly reduces system limitations.

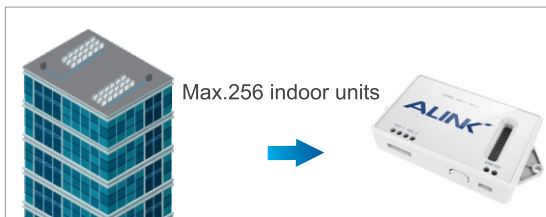

► Multiple Lock function

The new centralized controller could not only lock their own keyboards, it could also enable the users lock each unit's setting mode or remote controller.



► Weekly Schedule Control

The CC-02 centralized controller's weekly schedule timer function allows users to set up to four scheduled periods per day ,each with its own operation mode and temperature setting.

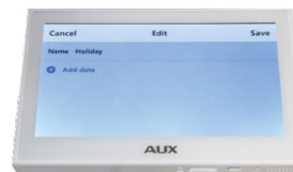

► Indoor Units Operation Status Display

Error and protection codes are shown directly on centralized controller's displays, no need to access outdoor unit's PCBs to obtain codes .The building management professionals could inquire a wide range of historical error and protection codes to get the system status information before contacting a service engineer.



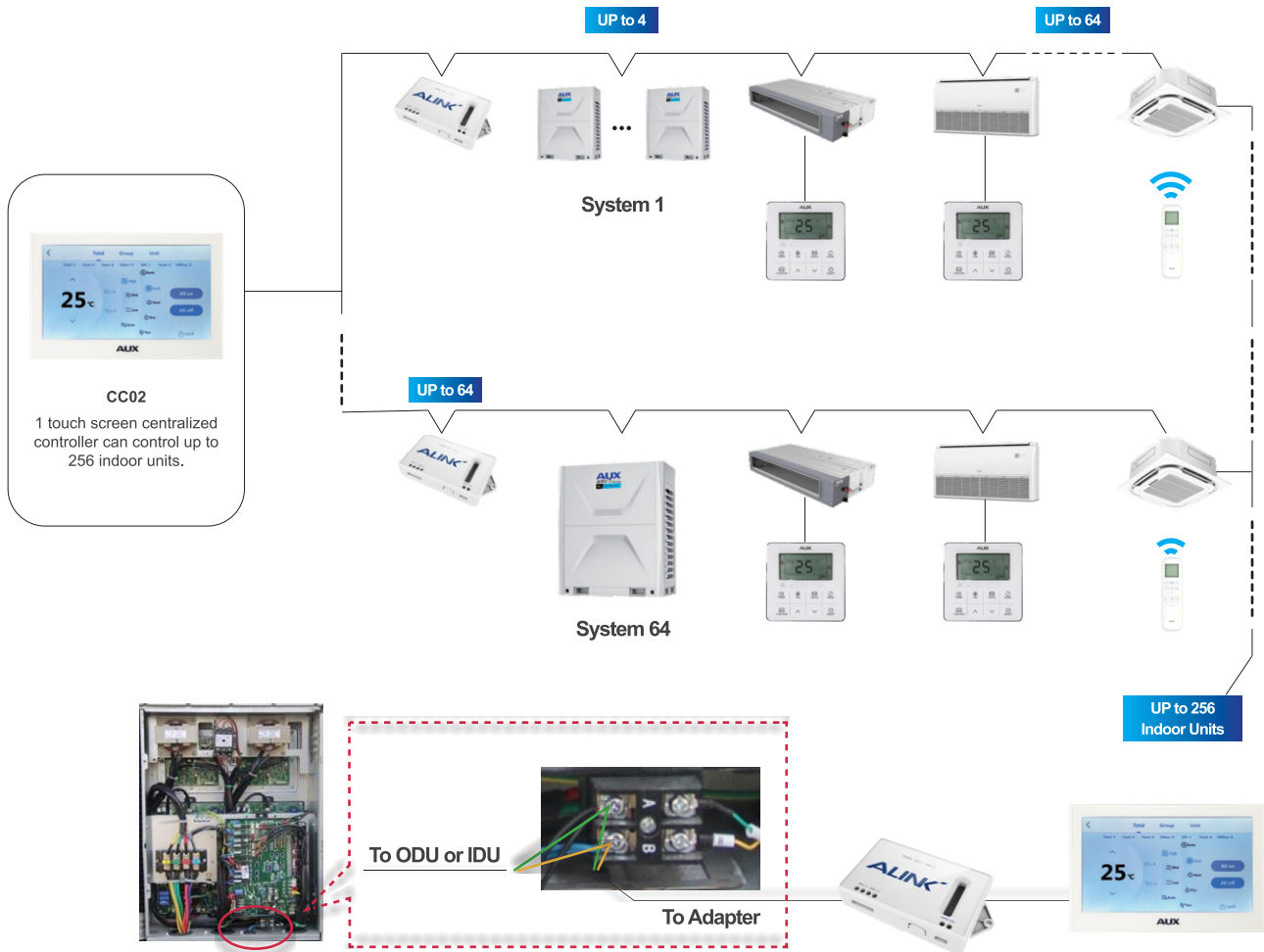

▶ Central controller & connection(produced before 2023.6.30)

The centralized controllers could be connected directly to the master outdoor unit or any indoor unit of each system .so it significantly simply wiring configuration.



Main Components of Centralized Controller

	CC-02	CM-MTD/AM01
Model		
Dimension(W×H×D) (mm)	176×116×12 (Outside the wall) 120×60×25 (Inside the wall)	127 ×65.8×20.8mm
Power supply	AC 180-240V (50/60Hz)	DC 12V

► Central controller & connection (produced after 2023.6.30)

Meet different air solution for kinds of application sites.

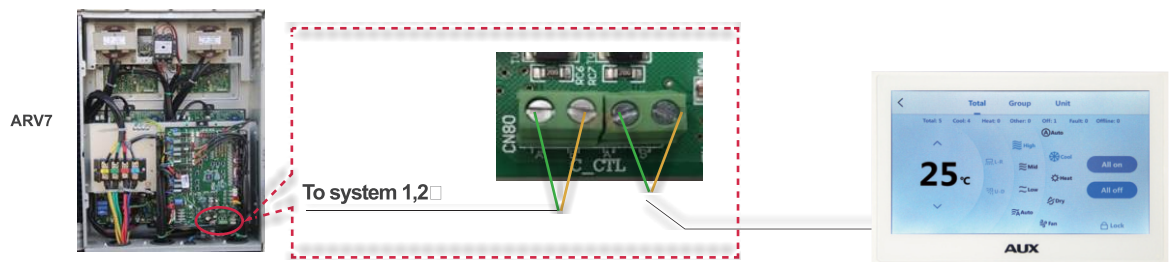
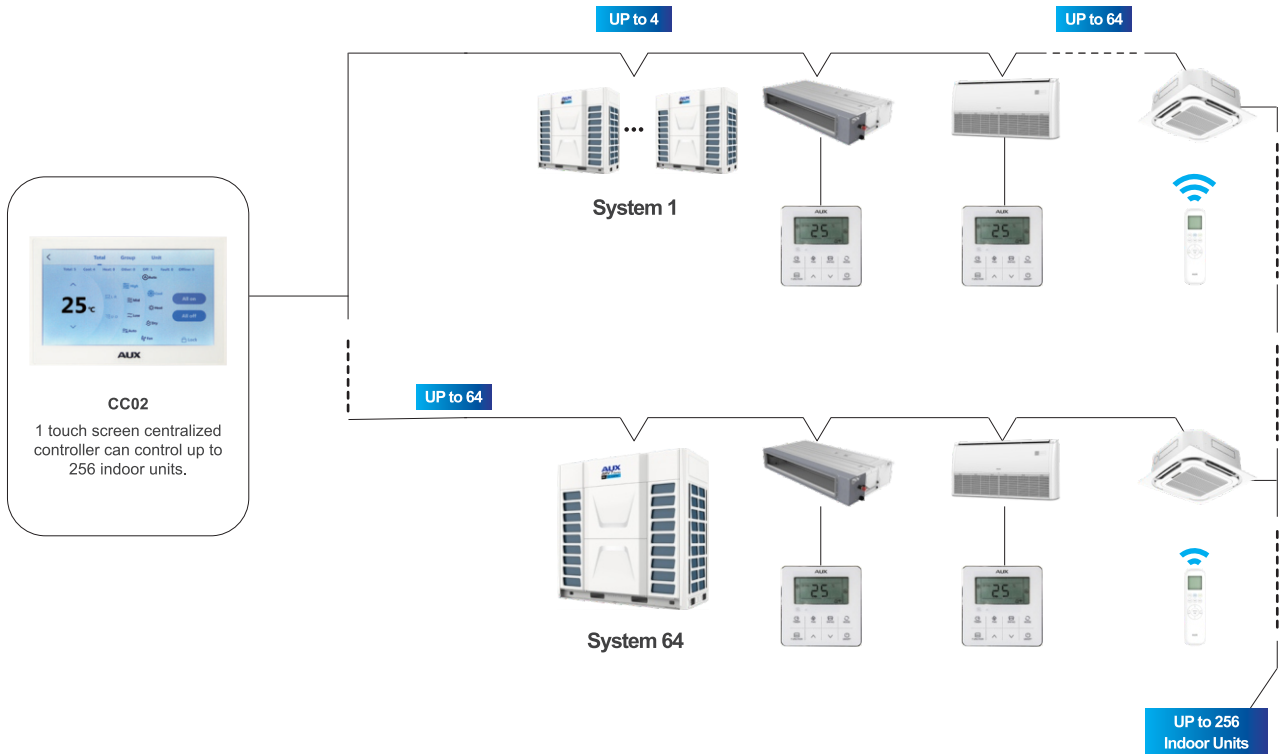

Notes:
It needs to set C9 and C10 parameters. For details, please contact AUX technical engineers